

CAC Meeting #4
October 29, 2019

South Park Blocks Master Plan Update - Design Concepts

PRESENTATION OUTLINE

1. Stakeholder Feedback
2. Design Objectives
3. Site Analysis Overview
4. Design Concepts
5. Kit of Parts Approach
6. Review of (3) Design Concepts in Detail
7. Discussion

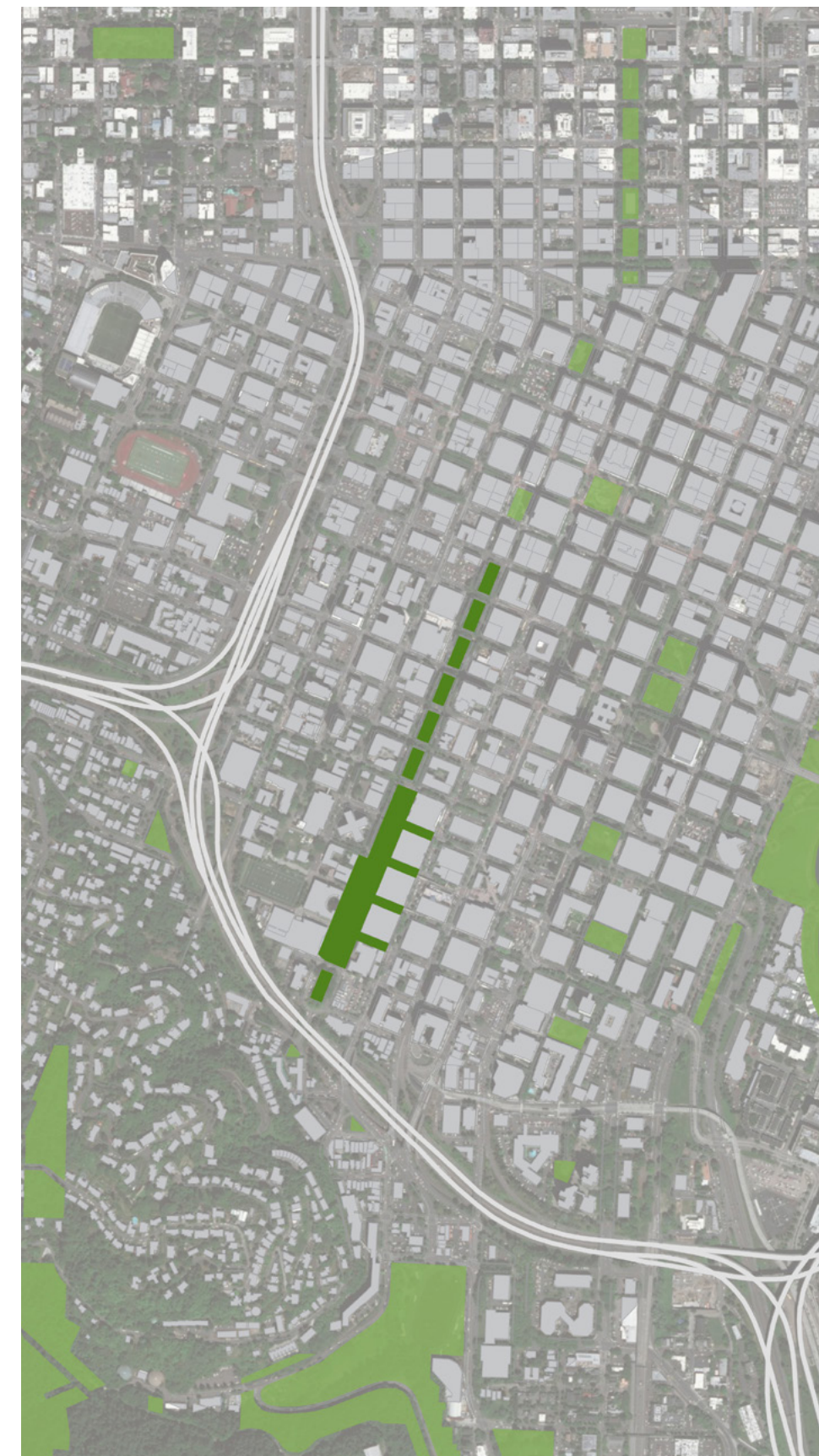

STAKEHOLDER FEEDBACK

COMMUNITY AND STAKEHOLDER ENGAGEMENT

TAC Meetings

CAC Meetings

Phase 1 Engagement Survey Results CAC's

Priority Issues and Opportunities Community

Event #1 (7/17/2019)

Concept Development Workshop (8/6/2019)

Upcoming:

Community Event #2 (11/23/2019)

Historic Landmarks and Design Commissions Urban

Forestry Commission

CAC Meeting #5

Presentations to various community / stakeholder groups

What historic or iconic features of the South Park Blocks are the most important to you? (ranked in order of importance)

- Trees
- Planting areas
- Pathway design
- Type of landscaping
- Statues/memorials/public art
- Lighting
- Plaza areas
- Material types



DESIGN OBJECTIVES

DESIGN OBJECTIVES

- Celebrate the South Park Blocks identity through defining features in both the University and Cultural District.
- Prioritize inclusive design and equitable experiences for people with differing abilities and backgrounds.
- Enrich the park experience through cultural events, performing arts and visual arts.
- Strengthen relationship with the Native American Student and Community Center.
- Provide periodic flexible use space for events, farmers markets, fairs, exhibits and live performances.
- Develop and expand specific program of appropriate elements or attractions.
- Consider methods to increase the sustainability and resiliency of park resources.
- Consider micro-climate and user comfort in all seasons.
- Preserve and improve wildlife habitat and urban forest canopy over time.
- Facilitate maintenance and operations efficiencies.
- Improve the physical and perception of public safety.
- Continue to work with partners to support each other and identify mutually beneficial opportunities.
- Consider the need for a large public gathering hub in times of emergency.
- Improve circulation and physical safety at streets and street crossings.
- Explore possible street closures.
- Support multi-modal connections and implementation of the Green Loop.

SITE ANALYSIS

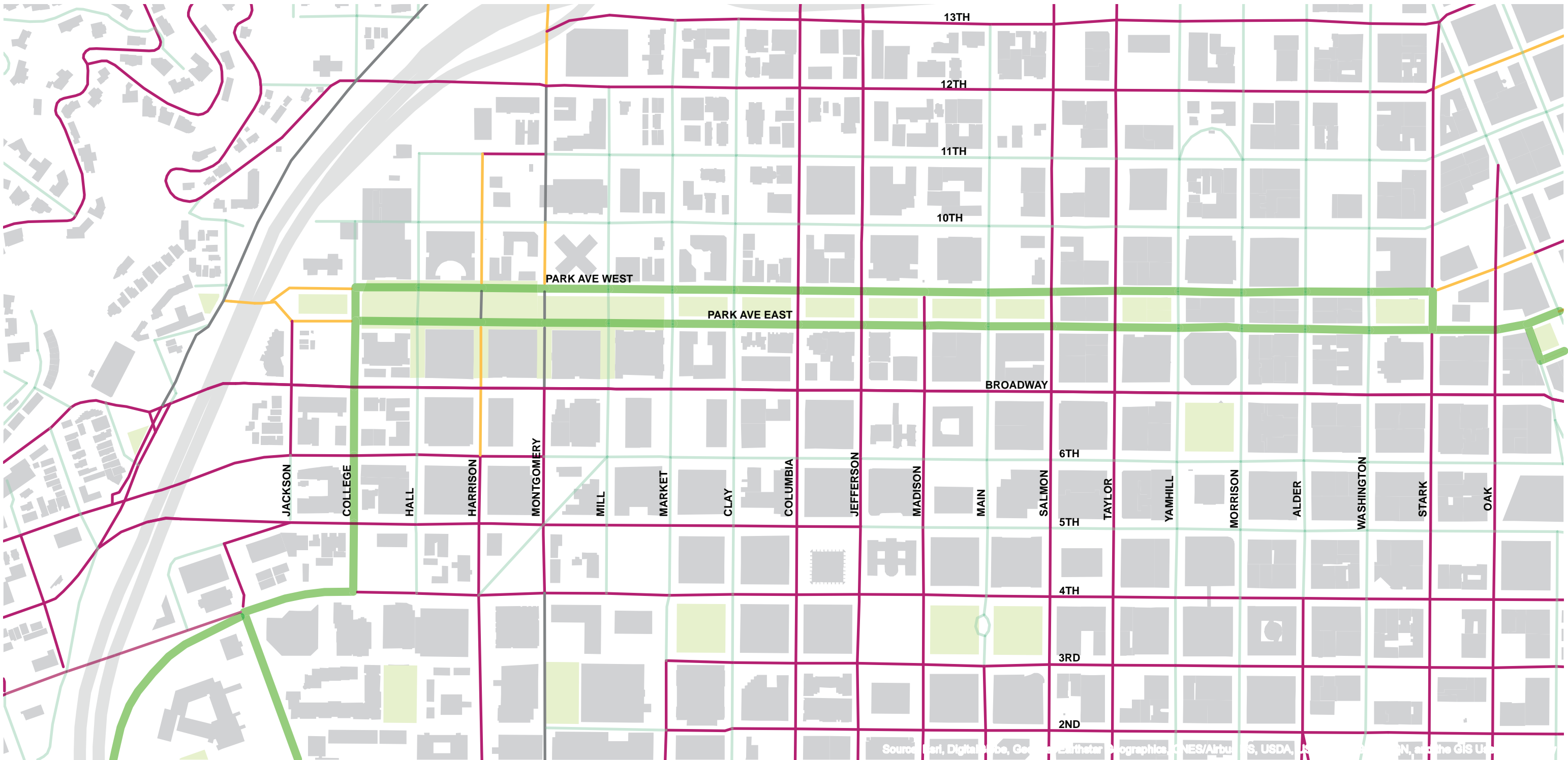

Source: Esri, DigitalGlobe, GeoEye, Earthstar Geographics, CNES/Airbus, USDA, USDA, USDA, AeroGRID, IGN, and the GIS User Community

2035 Bicycle Network Plan

GENERAL MAP FEATURES		
	Planting Areas	No Bike Facility
	Building Footprints	Neighborhood Greenway
		Off-street Trail or Path
		Bikeway
		Green Loop

Source:
PortlandMaps Open Data, SouthParkBlocks_ex-
pandedbasemap.dwg, Portland Bureau of
Transportation, Central City in Motion



CIRCULATION PATTERNS OVER TIME

University District Character

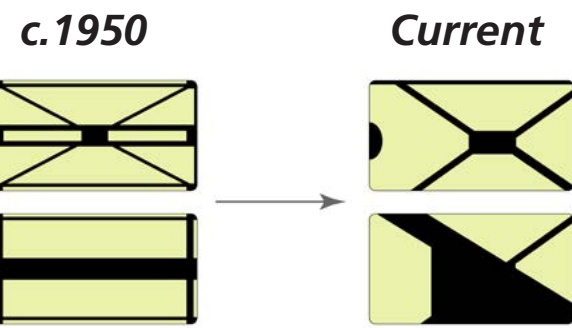

Cultural District Character

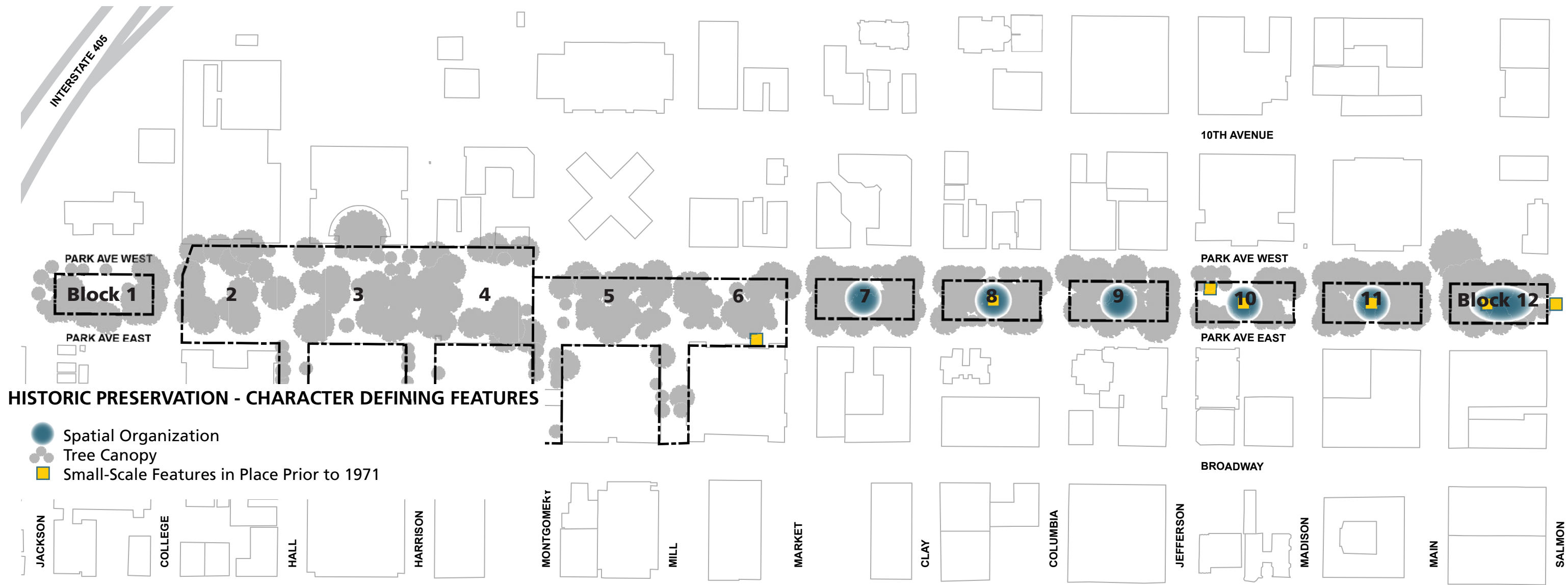
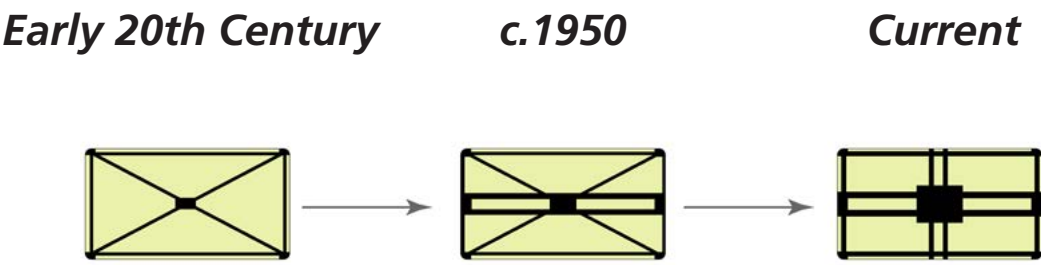

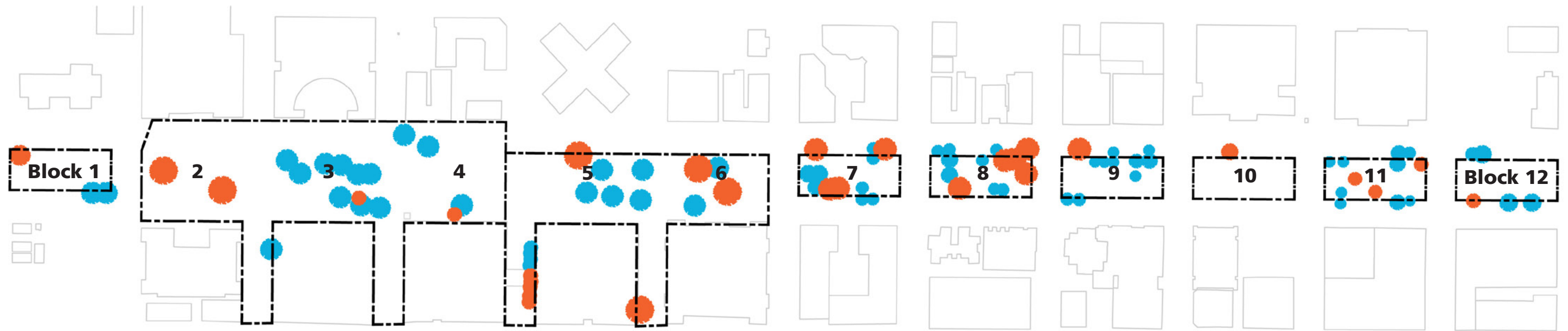

ISSUES Trees for Removal

OPPORTUNITIES Optional Trees for Removal

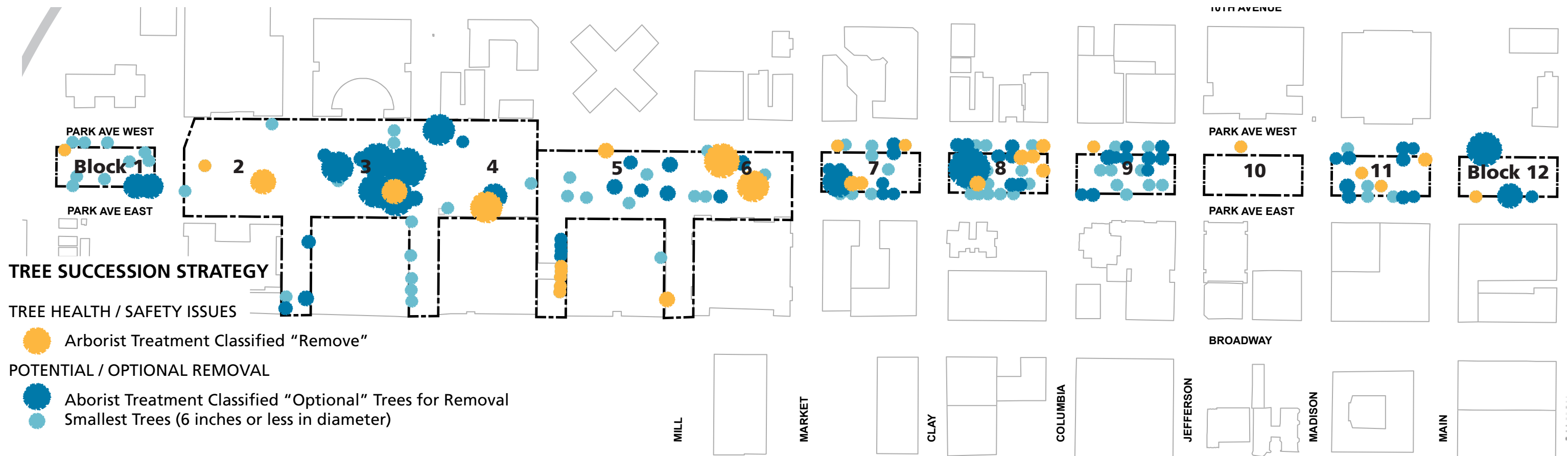

TREE SUCCESSION STRATEGY

TREE HEALTH / SAFETY ISSUES

Arborist Treatment Classified "Remove"

POTENTIAL / OPTIONAL REMOVAL

Arborist Treatment Classified "Optional" Trees for Removal

Smallest Trees (6 inches or less in diameter)

Tree Analysis Highlights:

- **Tree succession plan should consider fewer trees to improve growing space, pruning existing trees to improve growing space, and incorporating species that are more tolerant of shade in dense areas where new trees are desired.**
- **52% (199) of inventoried trees are American elm (*Ulmus americana*) and elm hybrids (*Ulmus* spp.)**
- **Tree diameter:**
 - 20% of trees smaller than 6-inches
 - 50% between 6- and 24-inches
 - 30% larger than 24-inches
- **Some young trees are struggling**
 - lack of overhead growing space shade intolerance
 - many developing with poor structure including one-sided crowns and lean.
- **Over 90% of the inventoried trees are in fair or good condition**
- **Treatment recommendations**
 - **75% of trees are classified as retain**
 - **29 trees (8%) classified as remove**
 - **68 (17%) optional**
- **Urban Forestry is currently reviewing these recommendations**



DESIGN CONCEPTS

South Park Blocks Master Plan Update Design Concepts

	Emerald Arrow Concept	Braided Districts Concept	Mirrored Chain Concept
Elements			
Spatial Organization	Historic character	Sequential related woven spaces	Block by block, responsive to immediate context
Pedestrian Experience	Central promenade	Enhanced corners	Diagonal "X" pattern
Trees	Long term tree health - retain rows of elms	Increased variety with aesthetic quality	Diverse canopy with conifers - biodiversity
Planting	Retain/Redistribute Cultural District Planters	Retain/Expand Cultural District Planters	Reconfigure to Diagonal Planters
Art	Added periodically throughout	Added to Cultural District closed streets	Added to Cultural District median islands
Terminus	Gateways at endpoints	Transition to Native American Center	Gateways at endpoints and midpoint
Street Treatments	Tabled intersections and closed streets	Narrowed roads to shorten crossing distances; closed streets	Periodic street medians
Focal Points	Added/Existing art and fountains, renovated Smith Amphitheater	Interactive play features, three district identities	Interactive art features, new plazas in University District
Green Loop	Perimeter along Park Ave West	Perimeter, diagonal connection	Perimeter along Park Ave East/West

KIT OF PARTS APPROACH

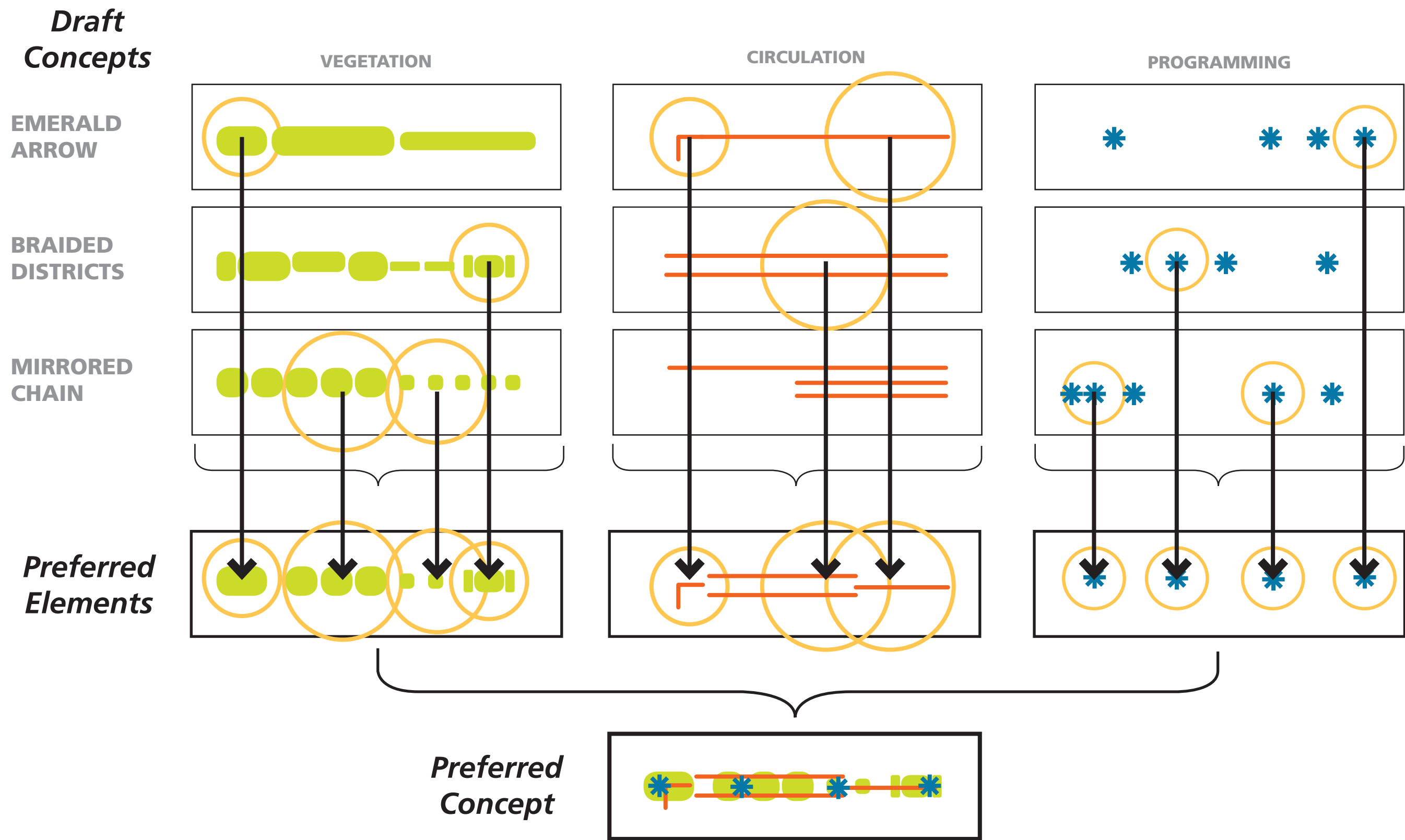

COMPILED CONCEPT LAYERS

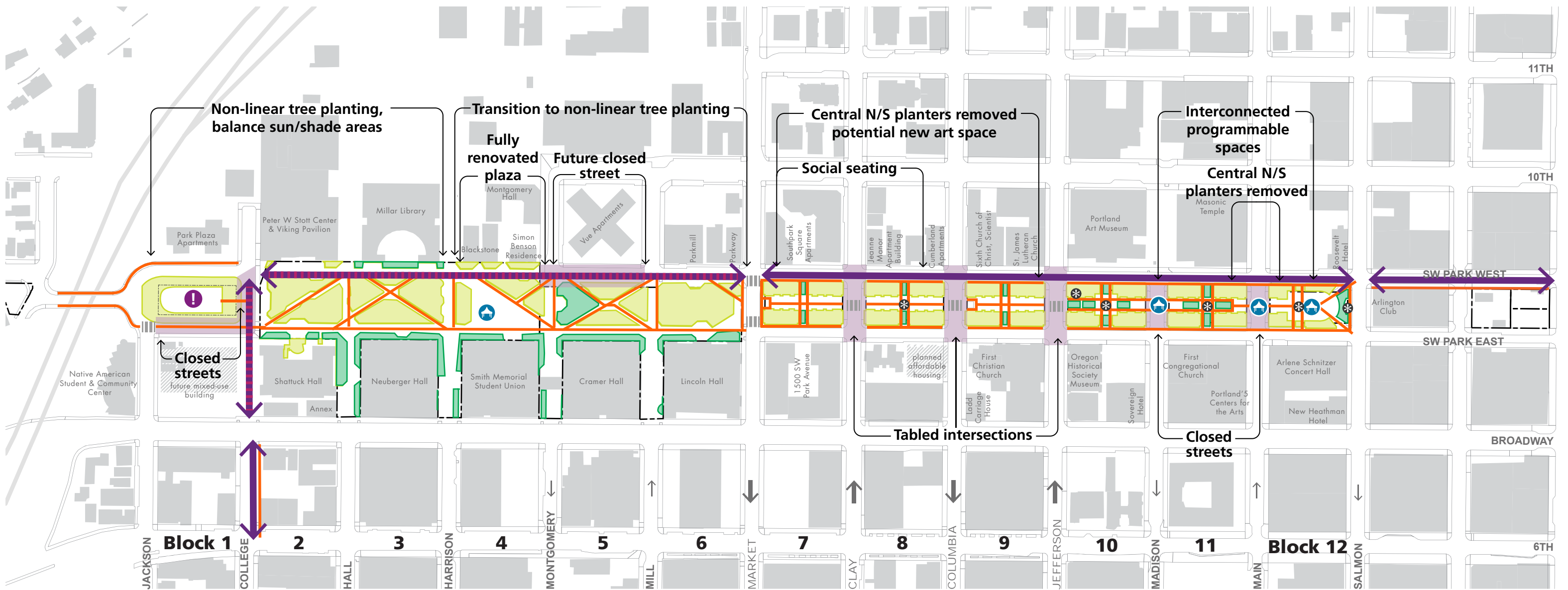

EMERALD ARROW CONCEPT

- Park Tax Lot
- Building Footprint
- Historic Small-Scale Features (in place prior to 1971)
- VEGETATION**
 - Lawn
 - Native / Ornamental / Flower Bed
- PROGRAMMING**
 - Event Location / Gathering Space
 - Interactive / Play Feature
- CIRCULATION**
 - Shared Use Path
 - Separated Bikeway
 - Pedestrian Path
 - Crosswalk
 - Potential Street Reconfiguration

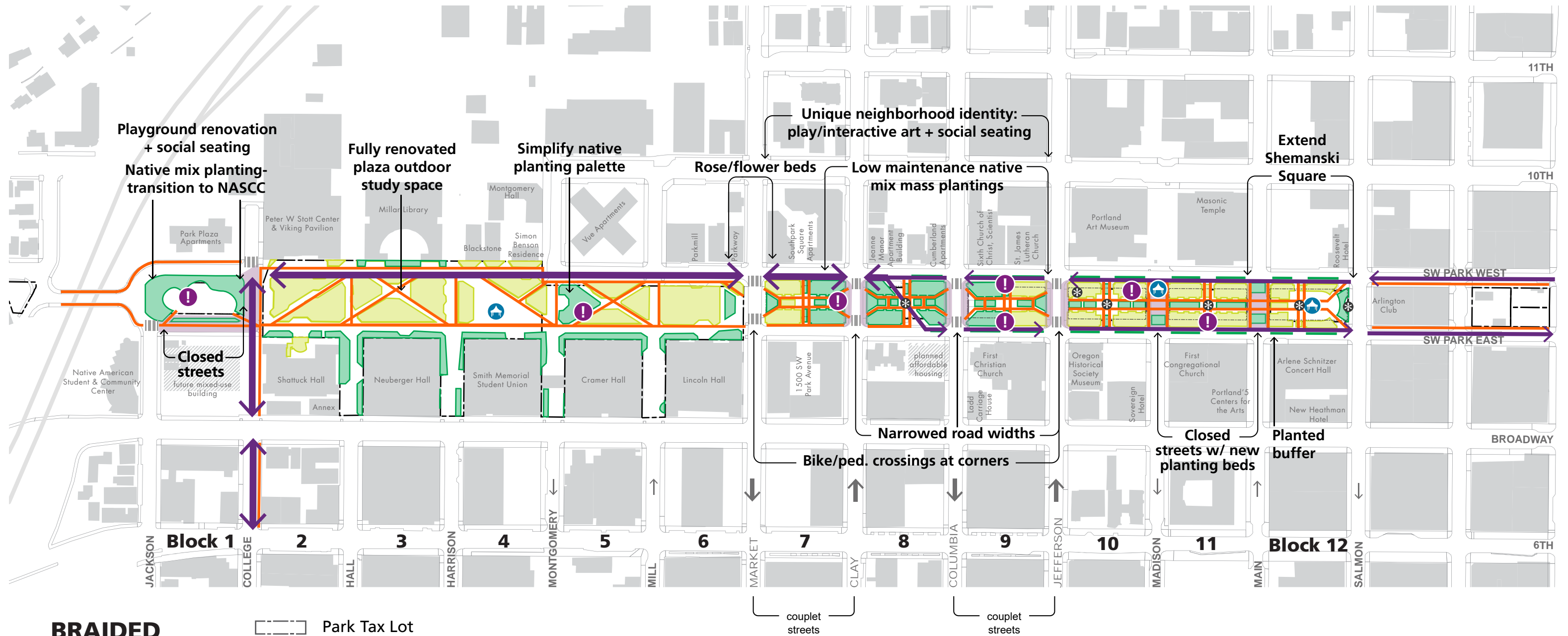

BRAIDED DISTRICTS CONCEPT

--- Park Tax Lot

■ Building Footprint

* Historic Small-Scale Features (in place prior to 1971)

VEGETATION

■ Lawn

■ Native / Ornamental / Flower Bed

PROGRAMMING

ⓘ Event Location / Gathering Space

! Interactive / Play Feature

CIRCULATION

← Shared Use Path

← Separated Bikeway

— Pedestrian Path

||||| Crosswalk

— Potential Street Reconfiguration

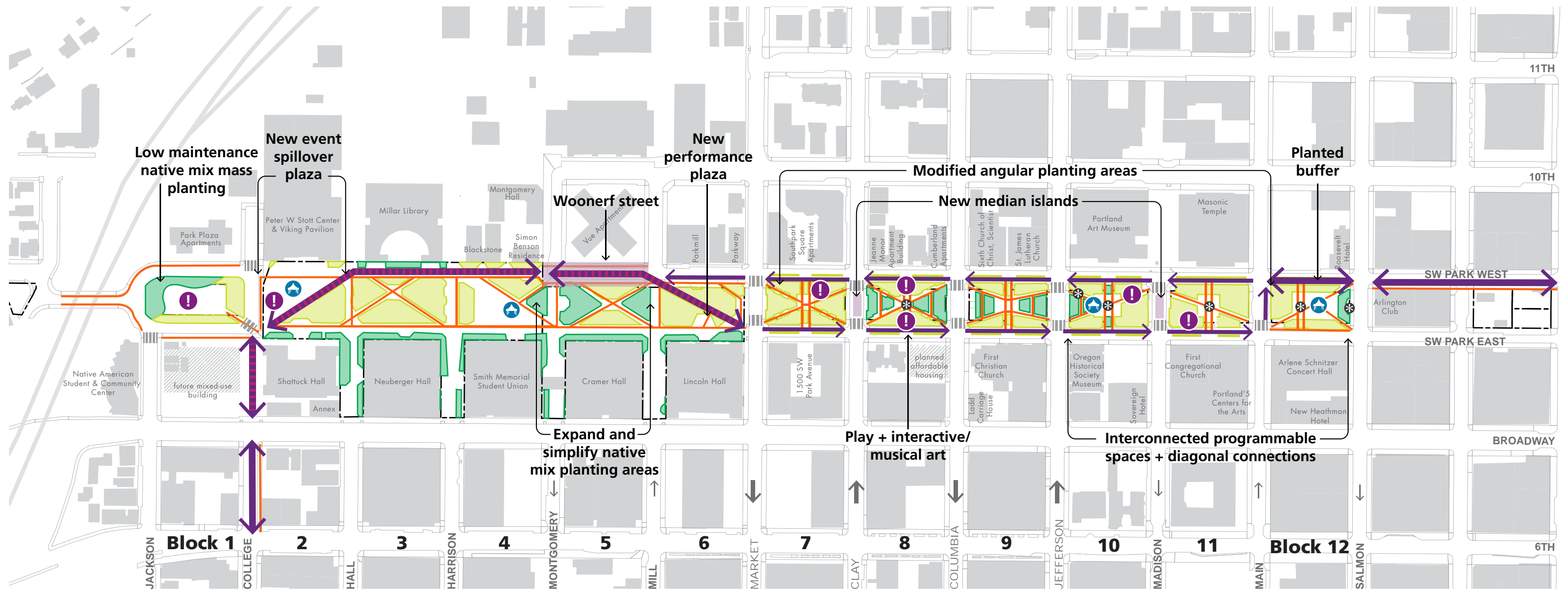

MIRRORED CHAIN CONCEPT

- | | |
|---|--|
| Park Tax Lot | |
| Building Footprint | |
| Historic Small-Scale Features <i>(in place prior to 1971)</i> | |
| VEGETATION | |
| Lawn | |
| Native / Ornamental / Flower Bed | |
| PROGRAMMING | |
| Event Location / Gathering Space | |
| Interactive / Play Feature | |
| CIRCULATION | |
| Shared Use Path | |
| Separated Bikeway | |
| Pedestrian Path | |
| Crosswalk | |
| Potential Street Reconfiguration | |

	Emerald Arrow Concept
<i>Elements</i>	
<i>Spatial Organization</i>	Historic character
<i>Pedestrian Experience</i>	Central promenade
<i>Trees</i>	Long term tree health - retain rows of elms
<i>Planting</i>	Retain/Redistribute Cultural District Planters
<i>Art</i>	Added periodically throughout
<i>Terminus</i>	Gateways at endpoints
<i>Street Treatments</i>	Tabled intersections and closed streets
<i>Focal Points</i>	Added/Existing art and fountains, renovated Smith Amphitheater
<i>Green Loop</i>	Perimeter along Park Ave West

EMERALD ARROW CONCEPT ELEMENTS



EMERALD ARROW CONCEPT

SPATIAL PATTERN



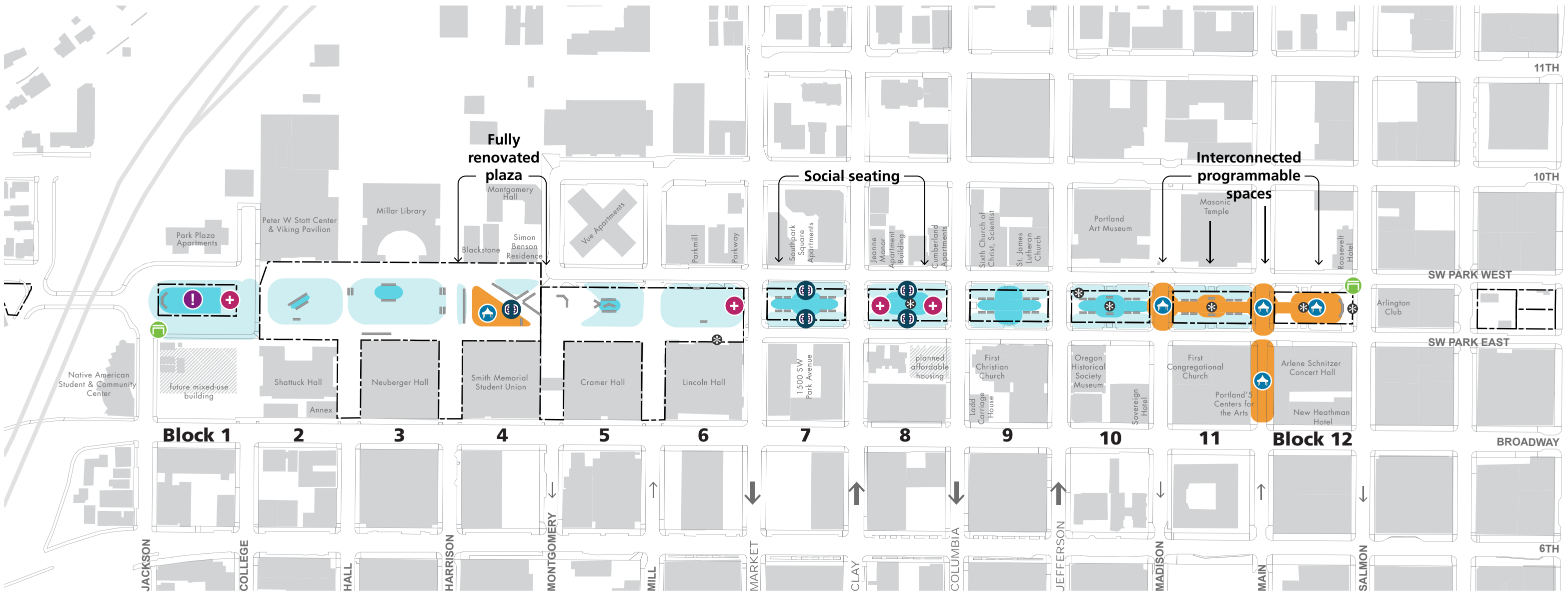

**EMERALD
ARROW
CONCEPT**

**PROGRAM
AND SPATIAL
ORGANIZATION**

- Park Tax Lot
- Building Footprint
- Historic Small-Scale Features *(in place prior to 1971)*
- Programmable Gathering Space *(larger events)*
- Small / Informal Gathering Space
- Flexible Open Space *(turf)*
- Programmable Space *(event location)*
- New Small-Scale Feature / Art Installation
- Interactive / Play Feature
- Gateway Feature
- Bench Seating
- Social Seating

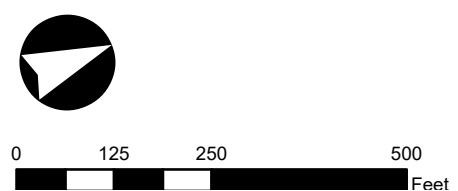



Passive Spaces in the Cultural District



Renovated Smith Plaza



Expanded Play Opportunities at PSU Playground



Circulation Around Art Focal Points

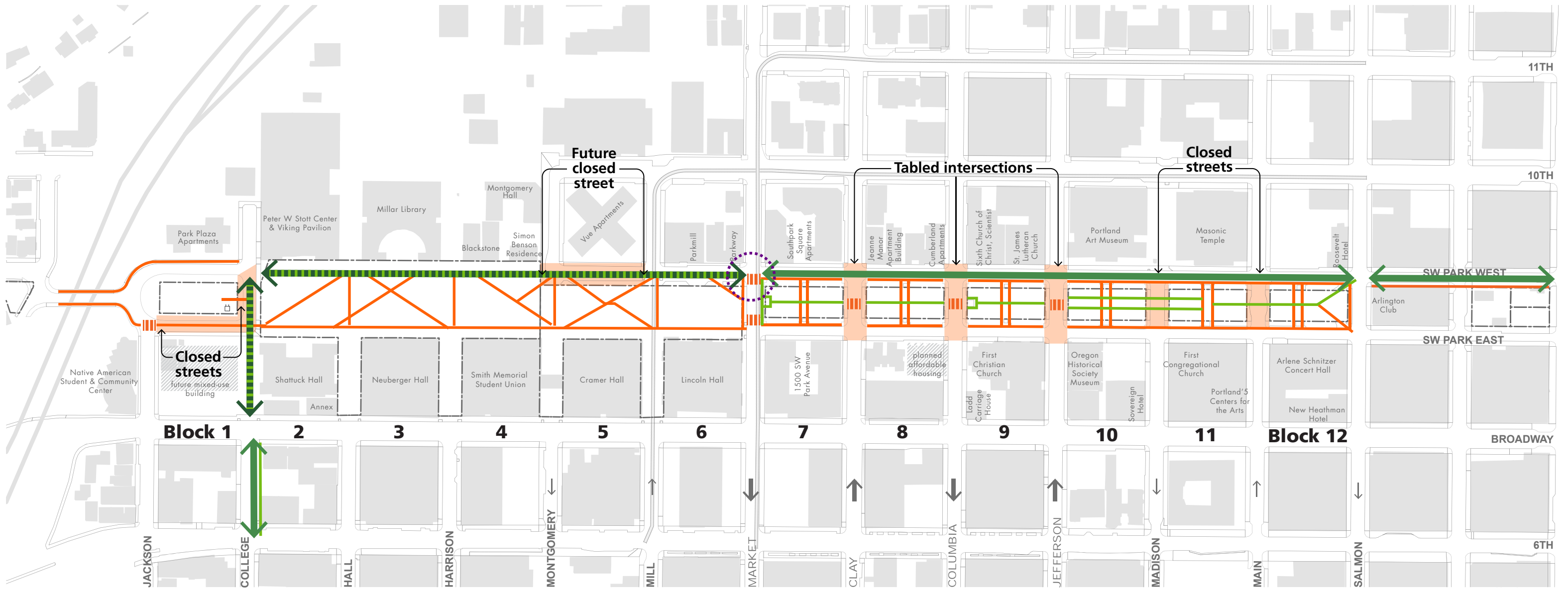

EMERALD ARROW CONCEPT

PEDESTRIAN AND BICYCLE CIRCULATION

- Park Tax Lot
- Green Loop - Shared Use Path
- Green Loop - Separated Bikeway
- Green Loop - Pedestrian
- Pedestrian - Other
- Crosswalk
- Potential Street Reconfiguration
- Potential Signalized Intersection



Central Promenade (Cultural District)



Existing Shared Use Path at PSU



Tabled Crosswalk (Cultural District)

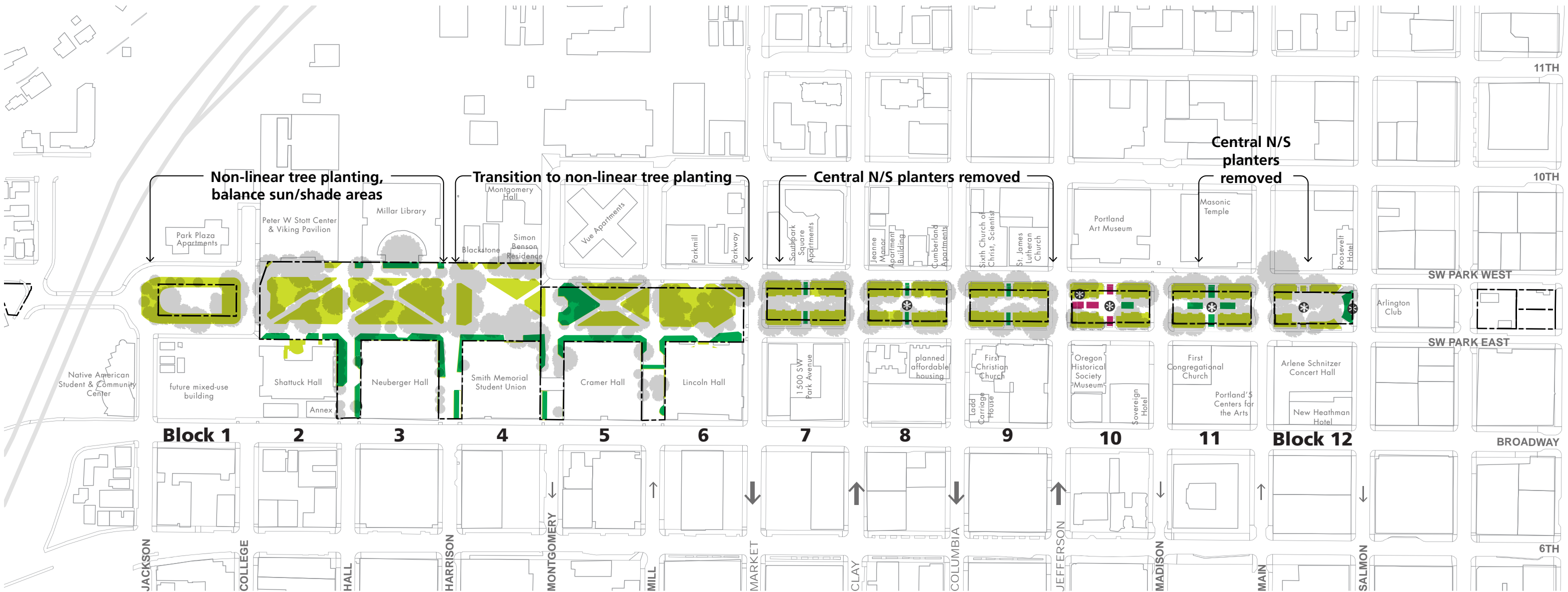

**EMERALD
ARROW
CONCEPT**

VEGETATION

- Park Tax Lot
- Historic Small-Scale Features (*in place prior to 1971*)
- Tree Canopy (*approximate*)
- Lawn
- Native / Ornamental Mix Plant Bed
- Rose Bed

Potential Tree Removals

- Arborist Classification "Retain"
- Arborist Classification "Optional"



Mature Elms Along Pedestrian Promenade Path (Cultural District)



Maintain Flexible Lawn Spaces (University District)

EMERALD ARROW CONCEPT

SW Jefferson St

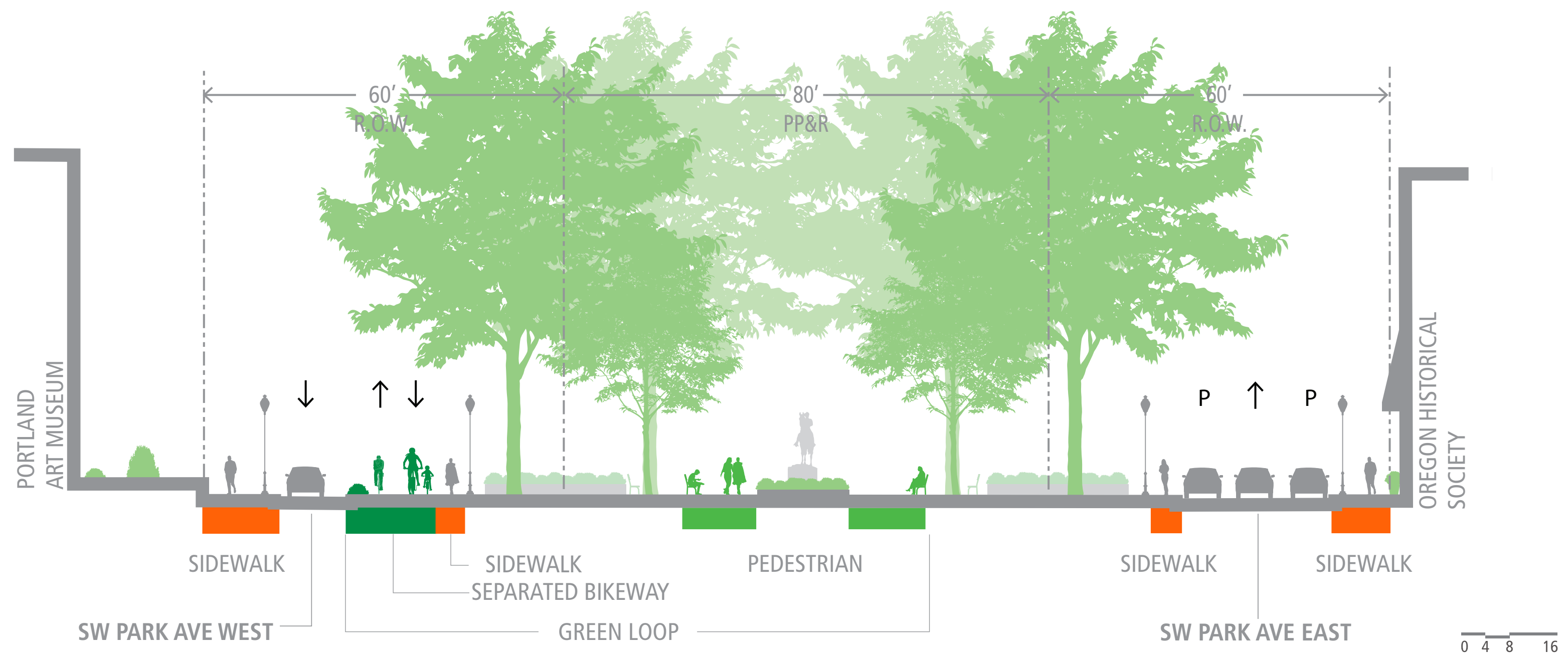
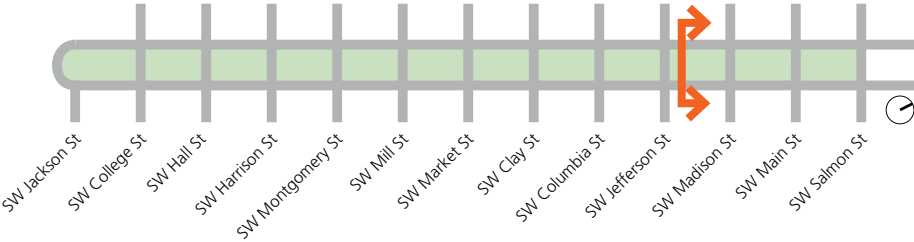

EMERALD ARROW CONCEPT

SW Hall St

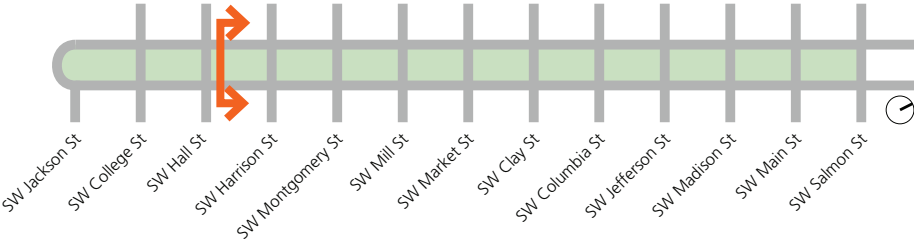

	Braided Districts Concept
Elements	
<i>Spatial Organization</i>	Sequential related woven spaces
<i>Pedestrian Experience</i>	Enhanced corners
<i>Trees</i>	Increased variety with aesthetic quality
<i>Planting</i>	Retain/Expand Cultural District Planters
<i>Art</i>	Added to Cultural District closed streets
<i>Terminus</i>	Transition to Native American Center
<i>Street Treatments</i>	Narrowed roads to shorten crossing distances; closed streets
<i>Focal Points</i>	Interactive play features, three district identities
<i>Green Loop</i>	Perimeter, diagonal connection

BRAIDED DISTRICTS CONCEPT ELEMENTS



BRAIDED DISTRICTS

SPATIAL PATTERN





Expanded Play Opportunities (throughout)



Larger Group Seating (University District)



Culturally Themed Art (throughout)



Social Seating (throughout)

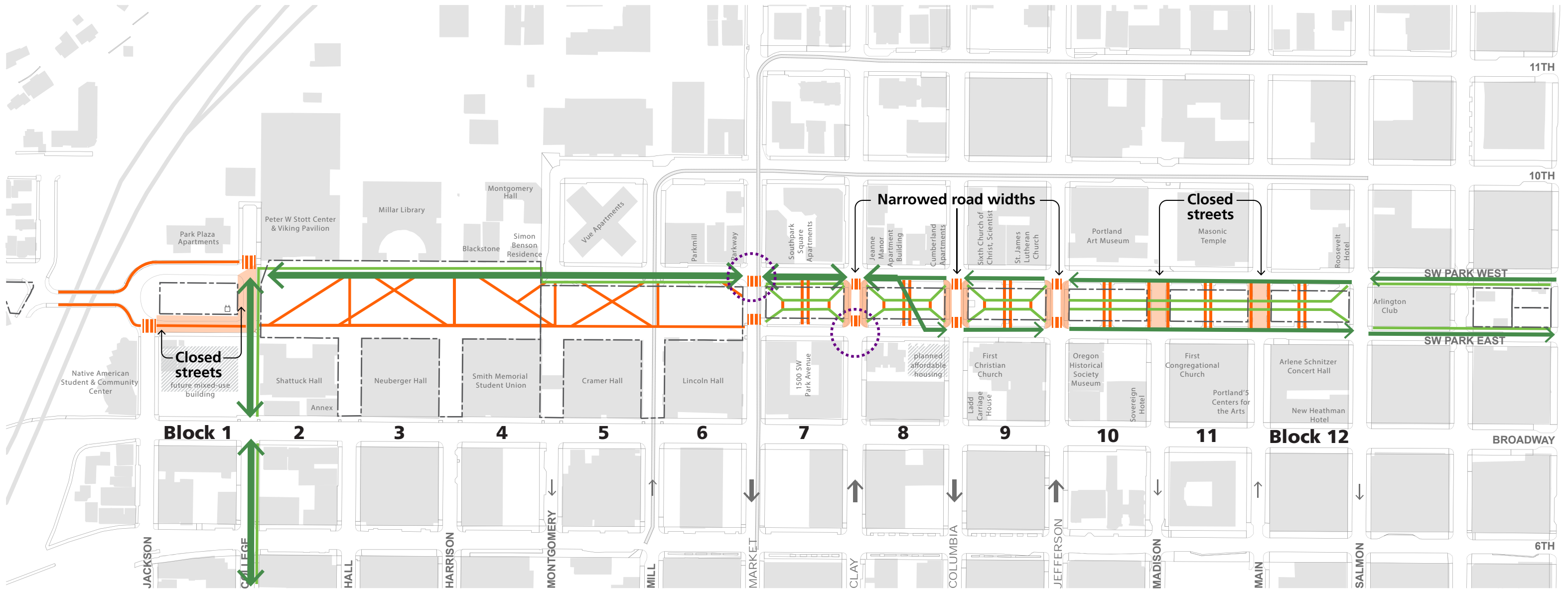

BRAIDED DISTRICTS CONCEPT

PEDESTRIAN AND BICYCLE CIRCULATION

- Park Tax Lot
- Green Loop - Shared Use Path
- Green Loop - Separated Bikeway
- Green Loop - Pedestrian
- Pedestrian - Other
- Crosswalk
- Potential Street Reconfiguration
- Potential Signalized Intersection



Separated Bikeway with Vegetated Buffer (Cultural District)



Narrowed Road Widths (Cultural District)



Separated Pedestrian & Bicyclists (University District)



BRAIDED DISTRICTS CONCEPT

VEGETATION

- Park Tax Lot
- Historic Small-Scale Features (*in place prior to 1971*)
- Tree Canopy (*approximate*)
- Lawn
- Native / Ornamental Mix Plant Bed
- Rose Bed

Potential Tree Removals



- Arborist Classification "Retain"
- Arborist Classification "Optional"



Smaller Canopy Deciduous Species (University District)



Simplified Low-Growing Natives (throughout)



Maintain Flexible Lawn Spaces (throughout)

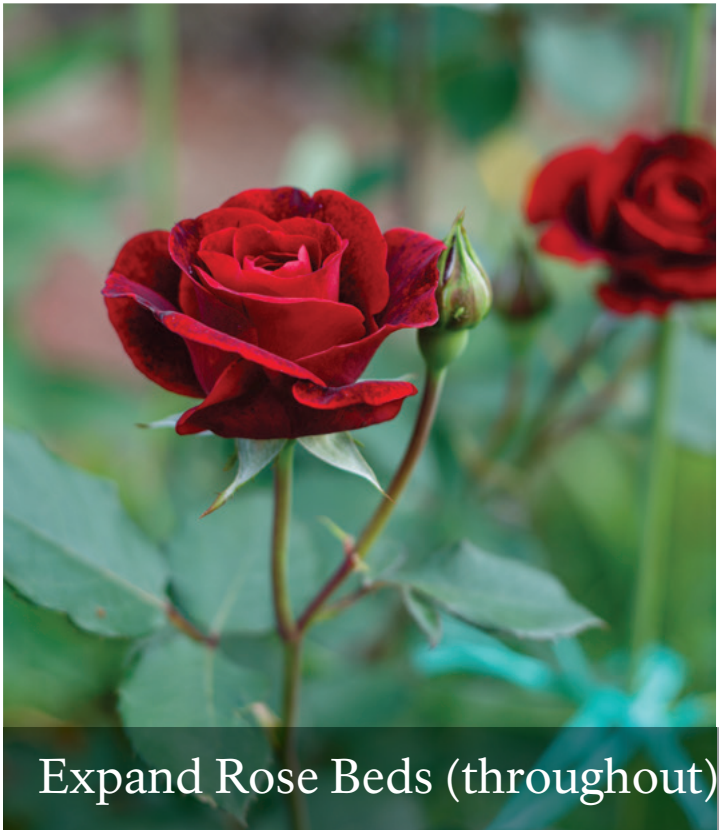

Expand Rose Beds (throughout)



BRAIDED DISTRICTS CONCEPT

SW Jefferson St

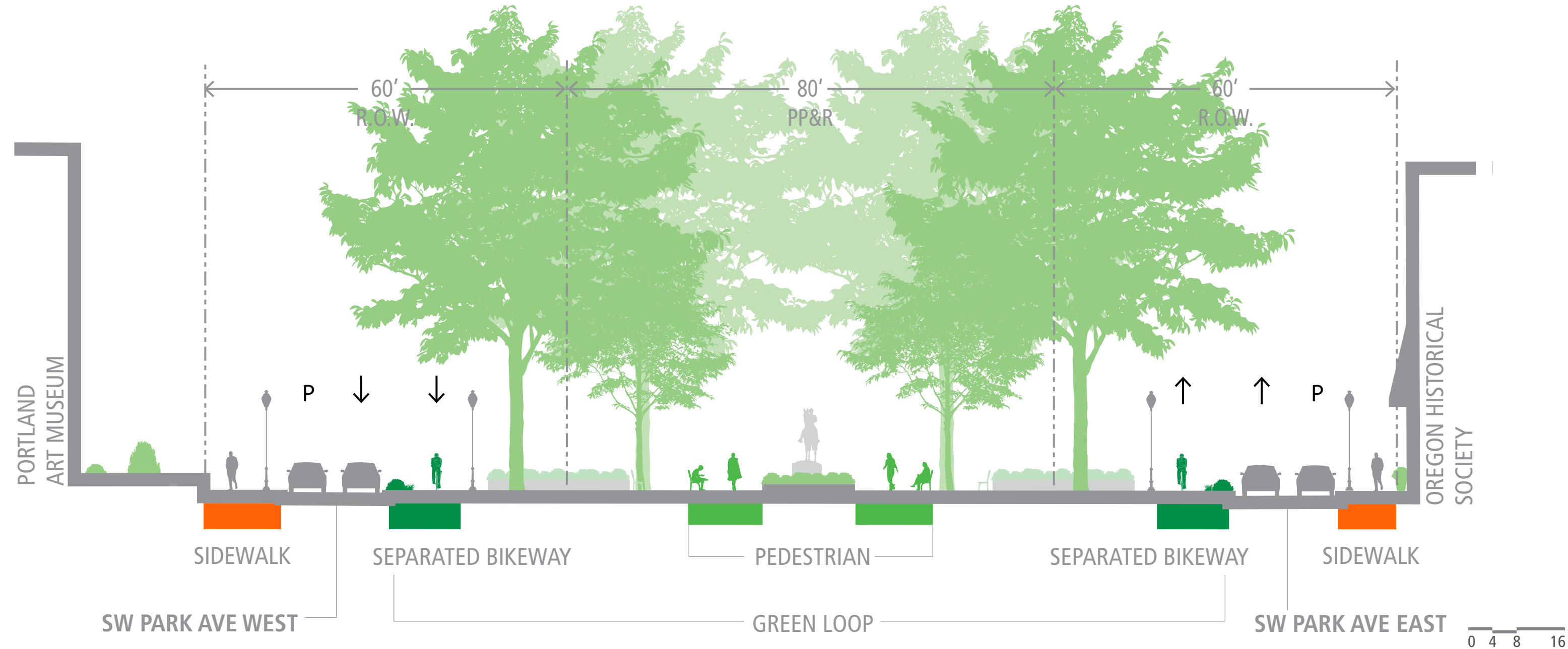
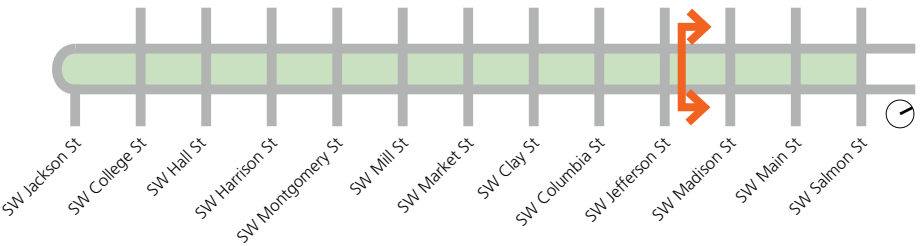

BRAIDED DISTRICTS CONCEPT

SW Clay St

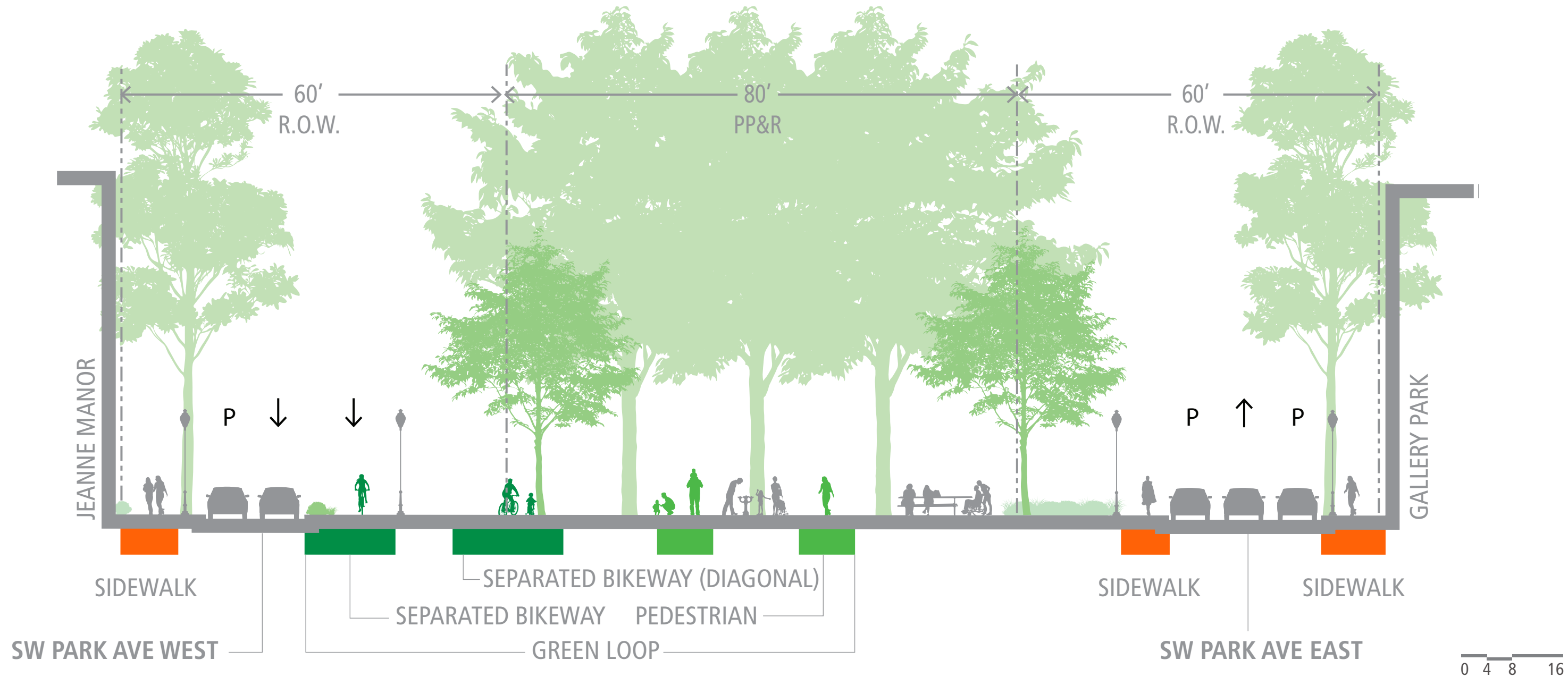
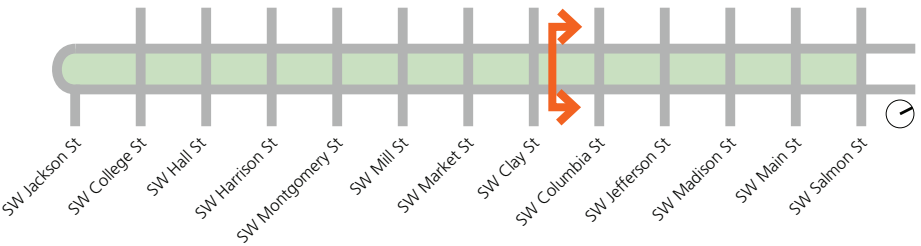

BRAIDED DISTRICTS CONCEPT

SW Mill St

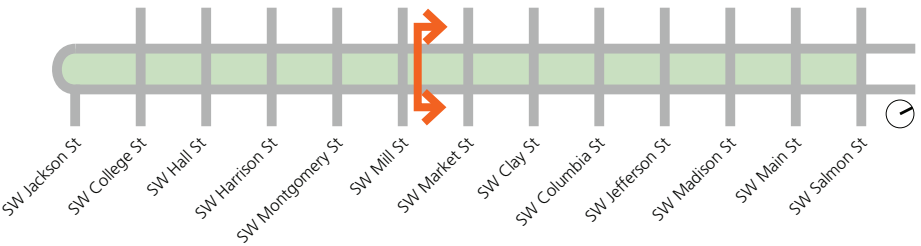

BRAIDED DISTRICTS CONCEPT

SW Hall St

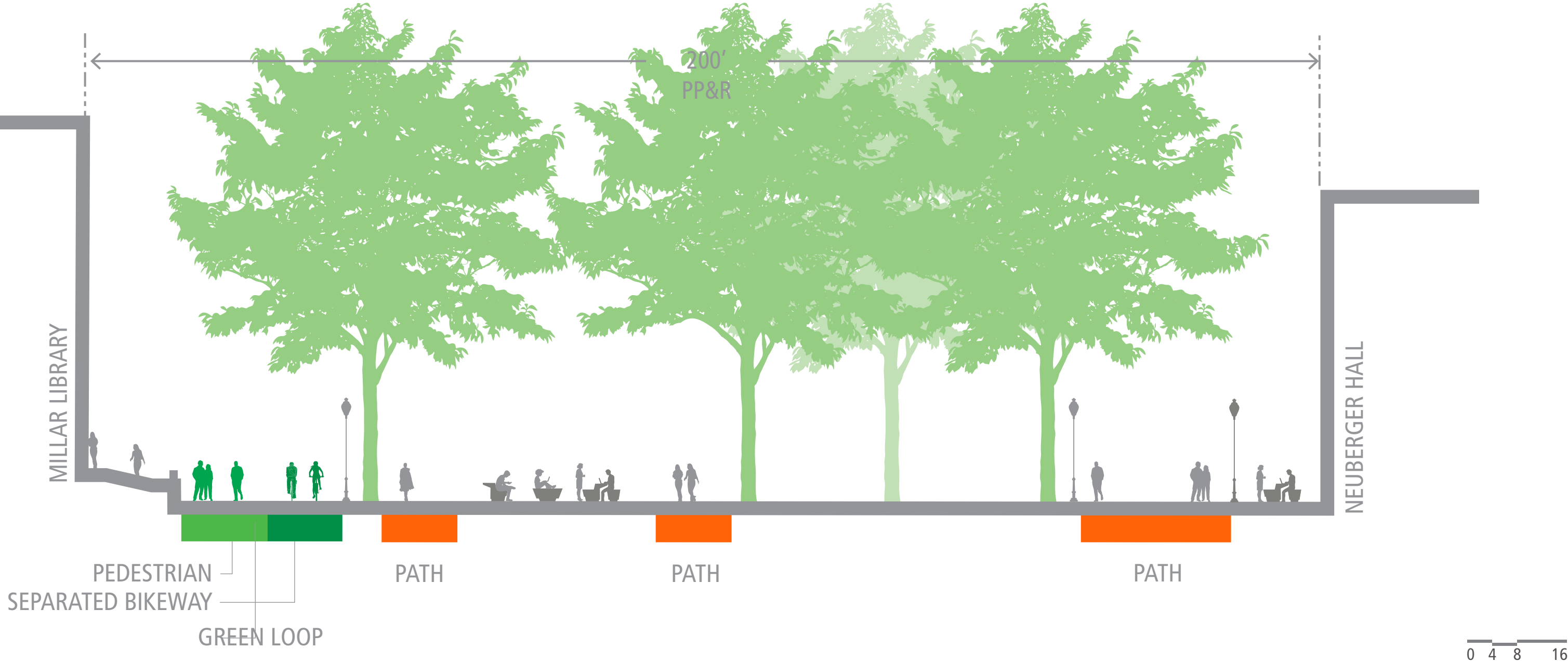
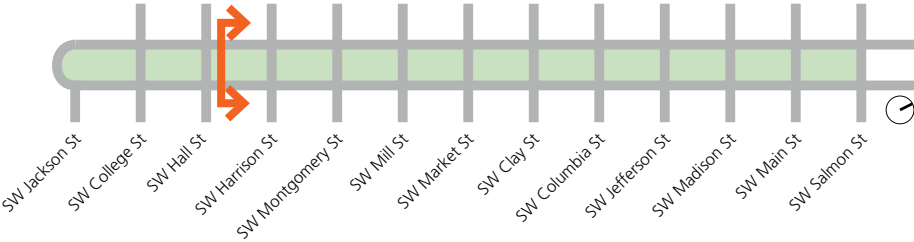

	Mirrored Chain Concept
Elements	
<i>Spatial Organization</i>	Block by block, responsive to immediate context
<i>Pedestrian Experience</i>	Diagonal "X" pattern
<i>Trees</i>	Diverse canopy with conifers - biodiversity
<i>Planting</i>	Reconfigure to Diagonal Planters
<i>Art</i>	Added to Cultural District median islands
<i>Terminus</i>	Gateways at endpoints and midpoint
<i>Street Treatments</i>	Periodic street medians
<i>Focal Points</i>	Interactive art features, new plazas in University District
<i>Green Loop</i>	Perimeter along Park Ave East/West

MIRRORED CHAIN CONCEPT ELEMENTS



MIRRORED CHAIN CONCEPT

SPATIAL PATTERN



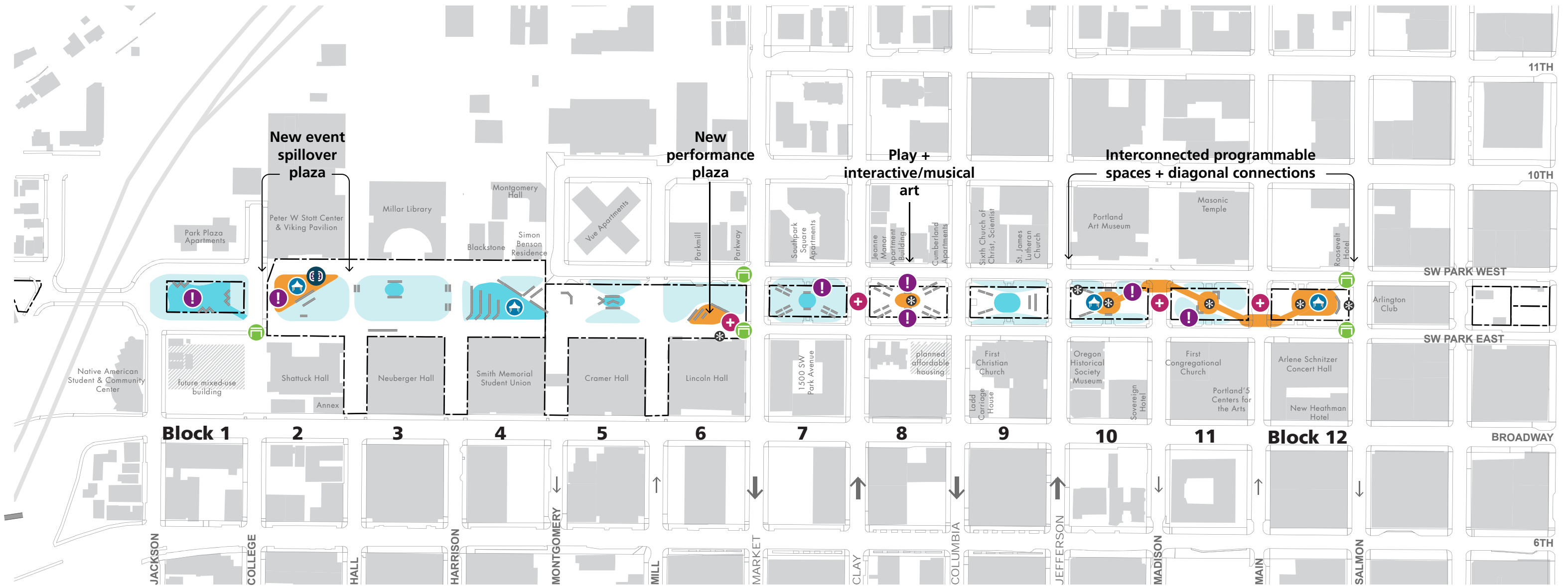

MIRRORED CHAIN CONCEPT

PROGRAM AND SPATIAL ORGANIZATION

- Park Tax Lot
- Building Footprint
- Historic Small-Scale Features *(in place prior to 1971)*
- Programmable Gathering Space *(larger events)*
- Small / Informal Gathering Space
- Flexible Open Space *(turf)*
- Programmable Space *(event location)*
- New Small-Scale Feature / Art Installation
- Interactive / Play Feature
- Gateway Feature
- Bench Seating
- Social Seating

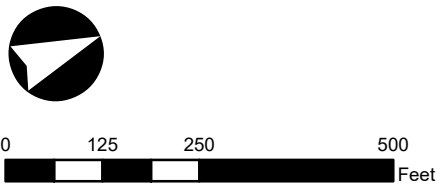



Interconnected Programmable Space (Cultural District)



Median Art Responsive to Cultural Institutions (Cultural District)



Event Spillover Plaza at Viking Pavilion (University District)



Interactive / Play Features (throughout)



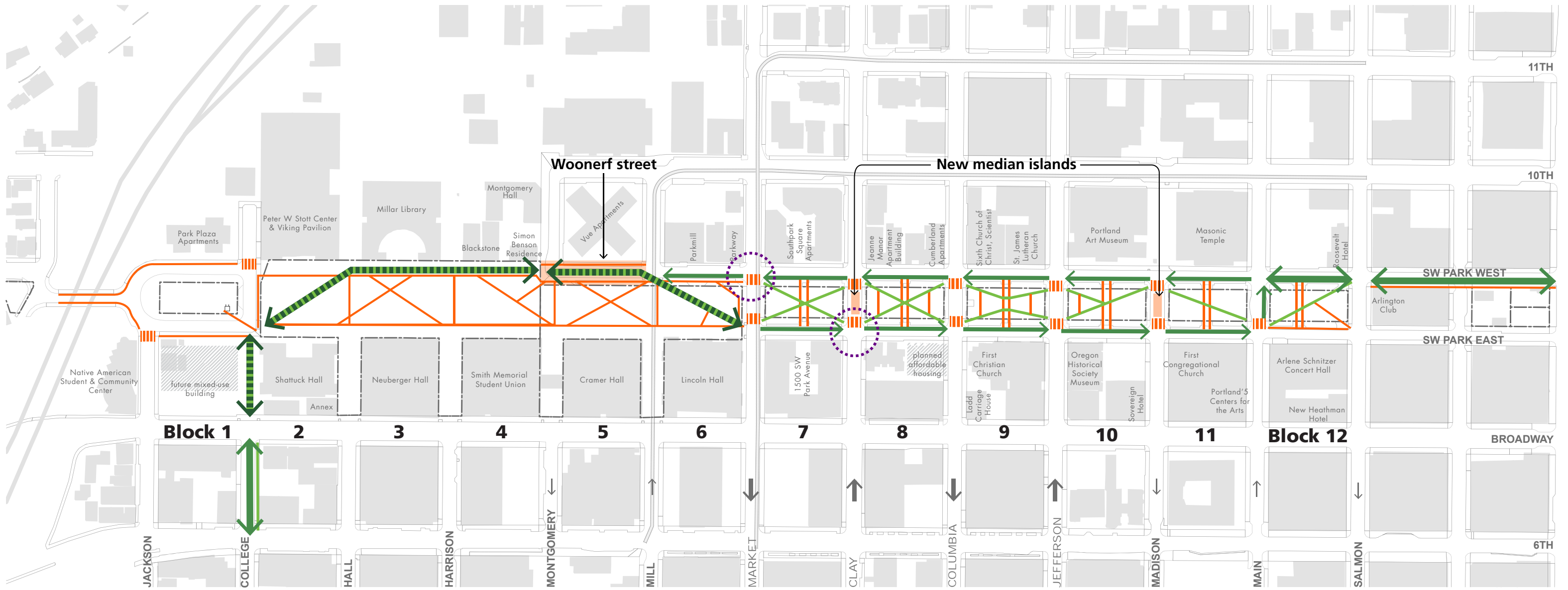

MIRRORED CHAIN CONCEPT

PEDESTRIAN AND BICYCLE CIRCULATION

- Park Tax Lot
- Green Loop - Shared Use Path
- Green Loop - Separated Bikeway
- Green Loop - Pedestrian
- Pedestrian - Other
- Crosswalk
- Potential Street Reconfiguration
- Potential Signaled Intersection



Separated Bikeway with Vegetated Buffer (Cultural District)



Median Islands (Cultural District)

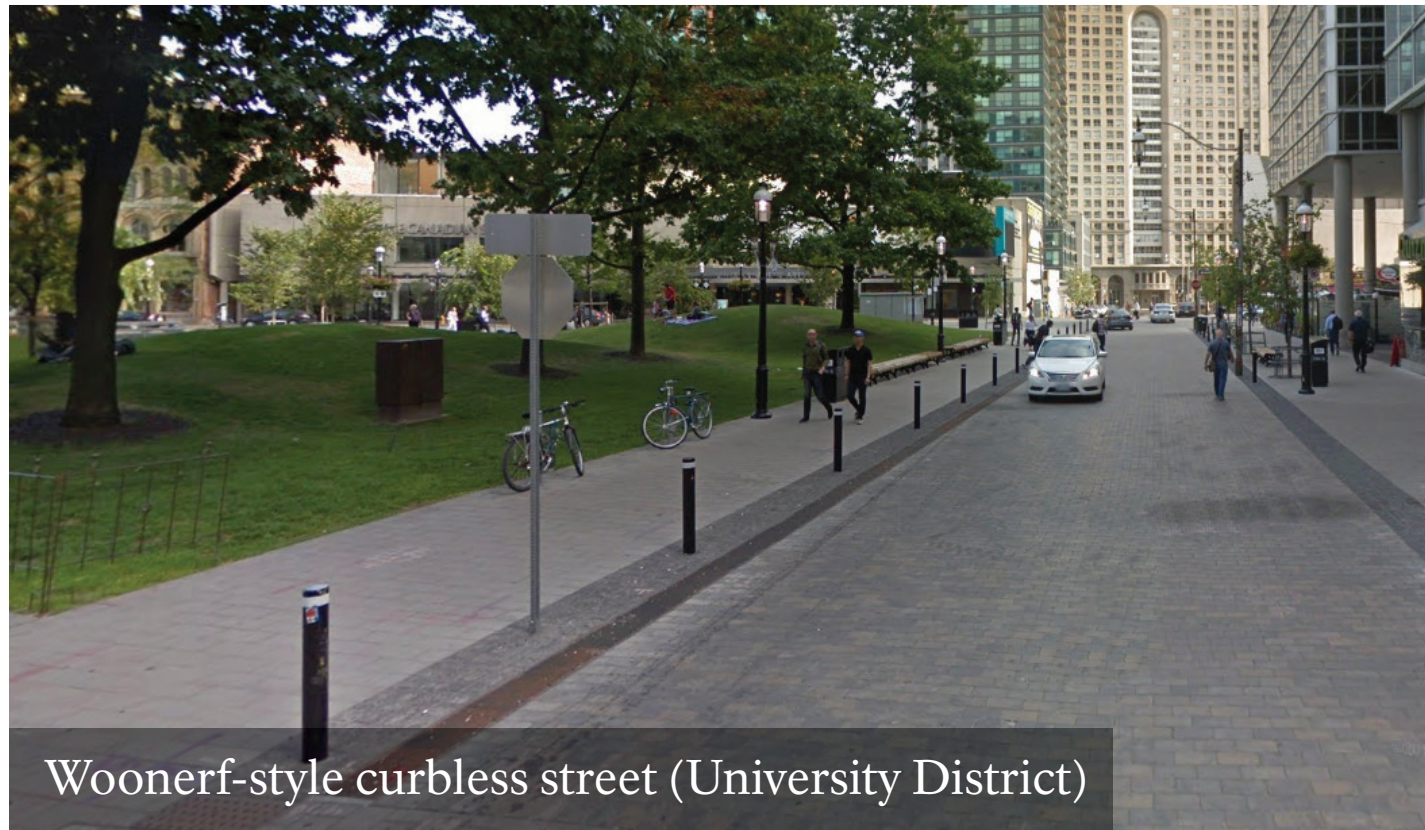

Woonerf-style curbless street (University District)

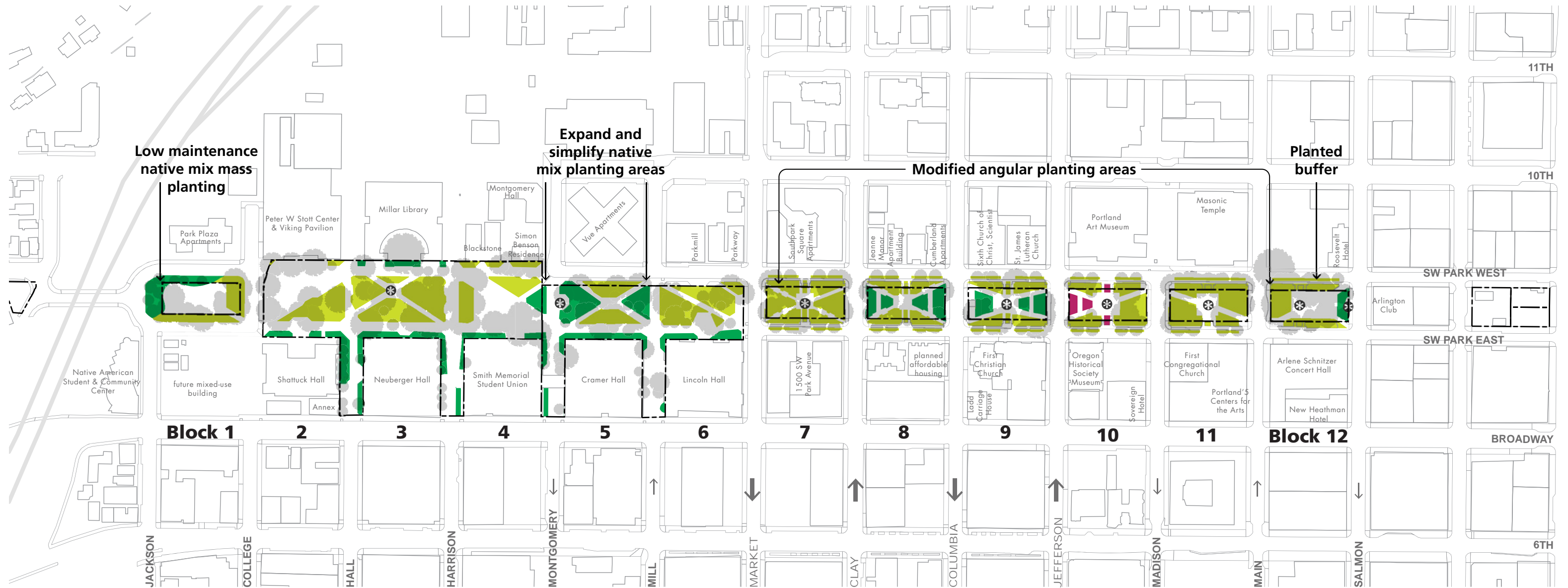

MIRRORED CHAIN CONCEPT

VEGETATION

- Park Tax Lot
- Historic Small-Scale Features (*in place prior to 1971*)
- Tree Canopy (*approximate*)
- Lawn
- Native / Ornamental Mix Plant Bed
- Rose Bed

Potential Tree Removals

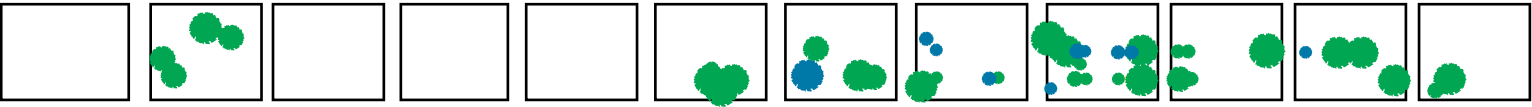

- Arborist Classification "Retain"
- Arborist Classification "Optional"

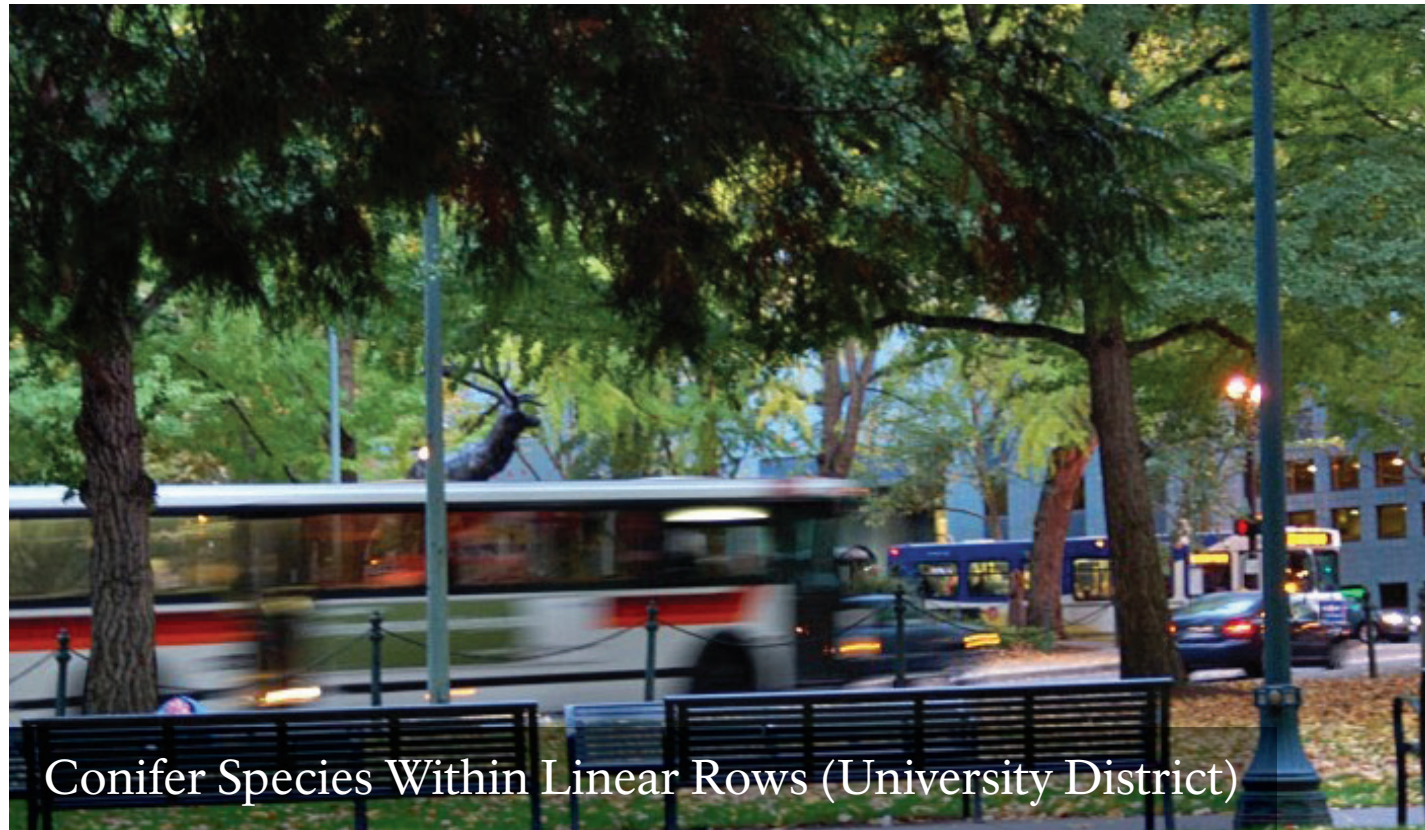

MIRRORED CHAIN CONCEPT

SW Jefferson St

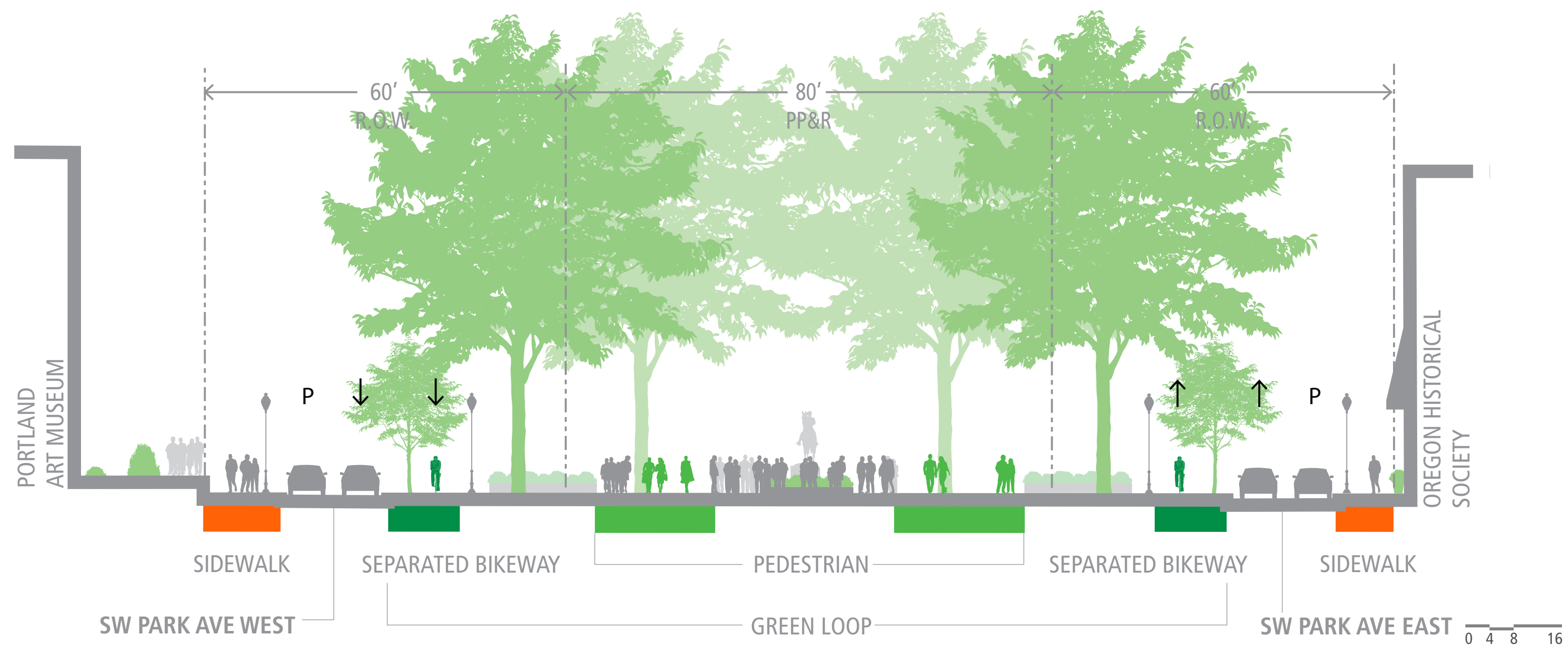
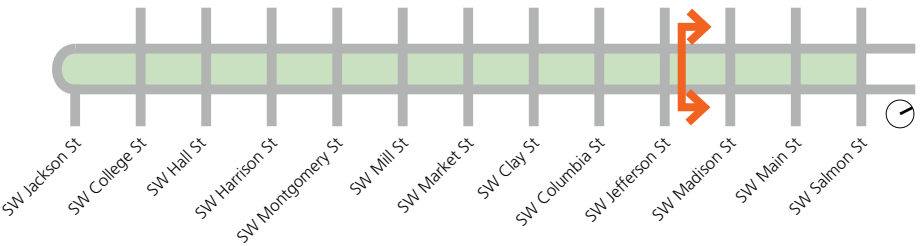

MIRRORED CHAIN CONCEPT

SW Clay St

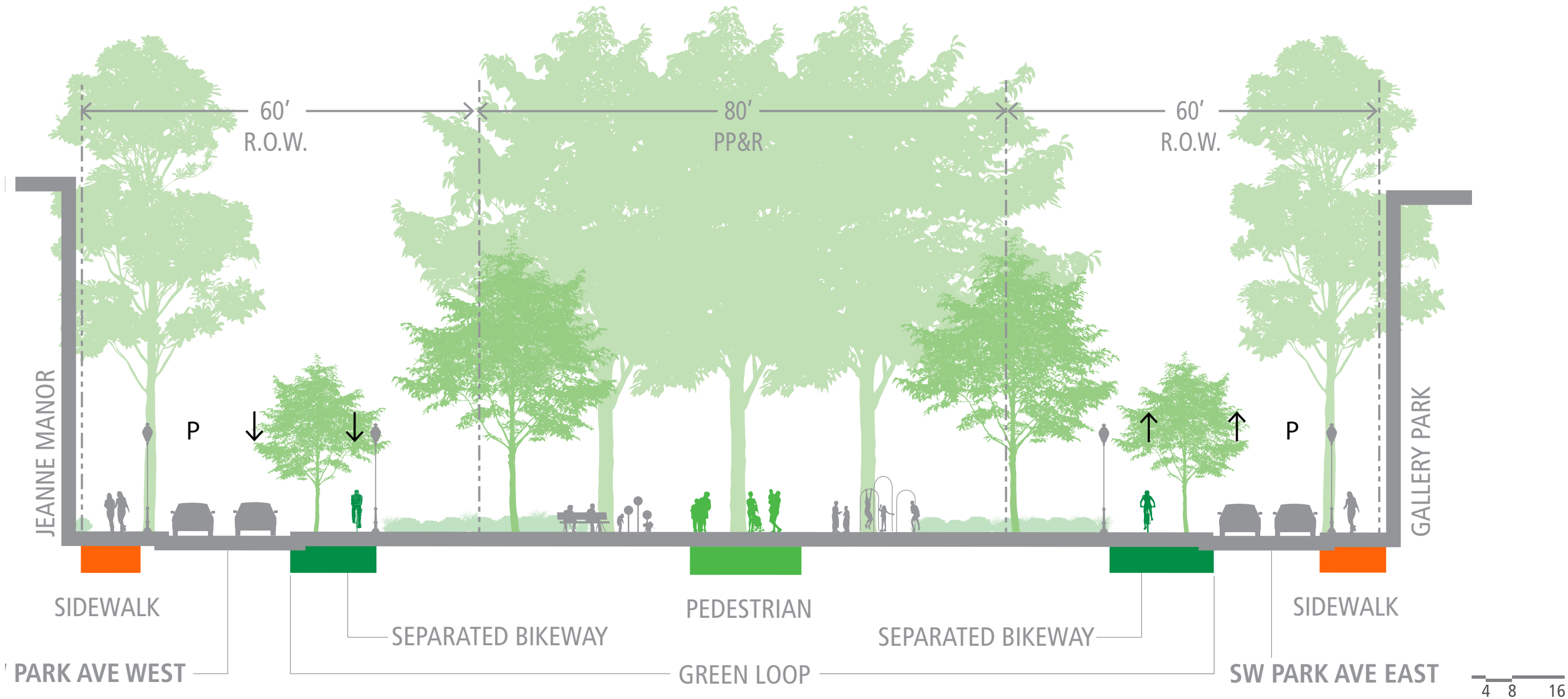
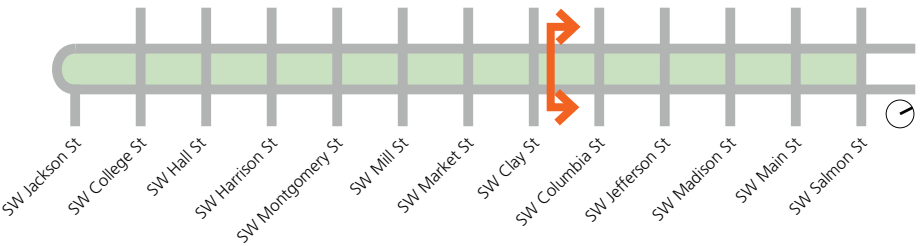

MIRRORED CHAIN CONCEPT

SW Mill St

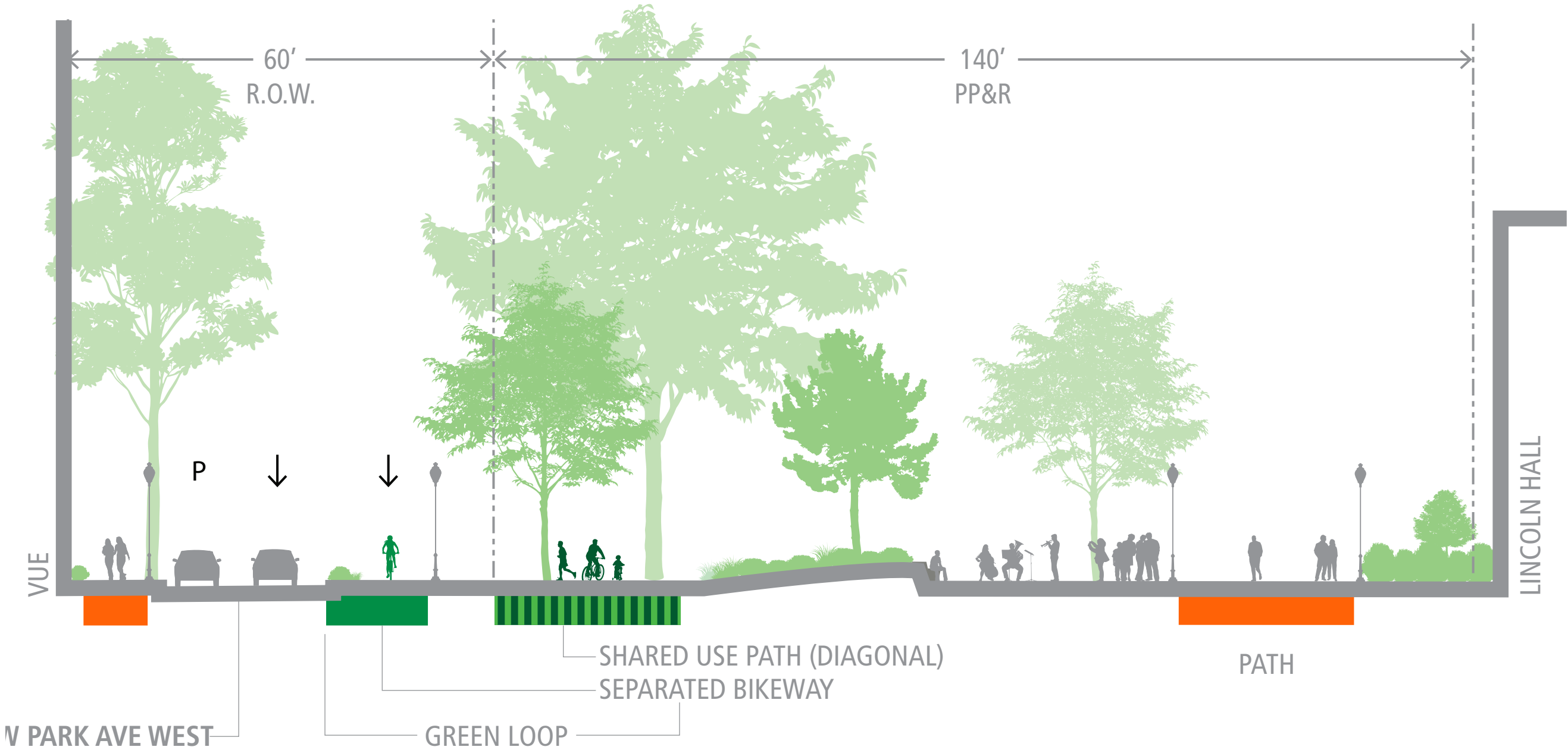
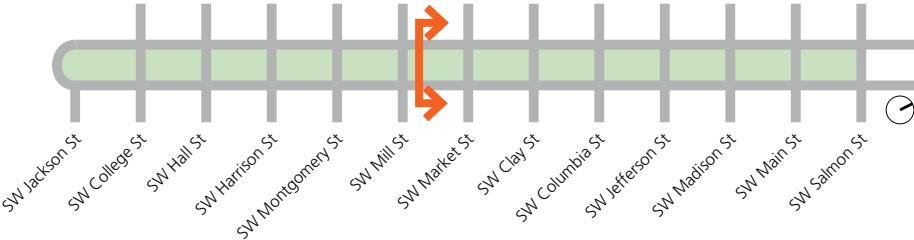

List of considerations that will be part of refining preferred concepts:

- Emergency and fire access
- Traffic management
- Maintenance and operations needs
- Accessibility and inclusive design
- Perceptions of and design for safety
- Electrical connections and lighting
- Tree succession planting strategy
- Irrigation
- Pavement materials

**All concept elements subject to further design detail and continued conversations with the community and technical advisors*

DISCUSSION